

ACC512 - Quick Start Guide



The ACC512 sits flush against or inside the door frame so that it is completely hidden when the door is closed for a more secure, professional looking install.

To mount the ACC512 create a recess in the door frame to house the Mag Lock and a recess in the door itself to house the locking plate. This allows the door to sit flush inside the frame concealing the Mag Lock in the process.

User Information

- There are no user serviceable parts, opening or attempting to repair the product will void the warranty.
- Do not install or use the device if the wires connected are damaged or have been subjected to water ingress.
- Handle the equipment carefully. The holding force can be reduced by damaging the lock body or armature plate.
- The magnetic lock should be fixed tightly on the door frame and the armature plate on the door leaf.
- Shut off all power to the access control system before wiring this device.
- Maintain a clean and safe environment at all times.

Definition

NO (Normally Open) - This is a contact which remains open (as default) until activated, during the "active" state the contact provides a closed circuit and starts conducting.

NC (Normally Closed) - Is the opposite of a NO contact. The contact will remain closed (as default) until activated, during the "active" state the circuit breaks and stops current flow.

Setup Example

Magnetic locks are an efficient method of adding secure access control to a door.

An electromagnetic lock works by holding the door in place as long as there is power being supplied.

For a "Fail Safe" setup, when the button is activated, power supply then releases power from the lock, and if power is lost then the lock also releases.

The Mag Lock can also be connected to a HRM250 - 10 function relay. A custom set length of time can be set for how long the power is cut from the Mag Lock. This allows for installations where the exit

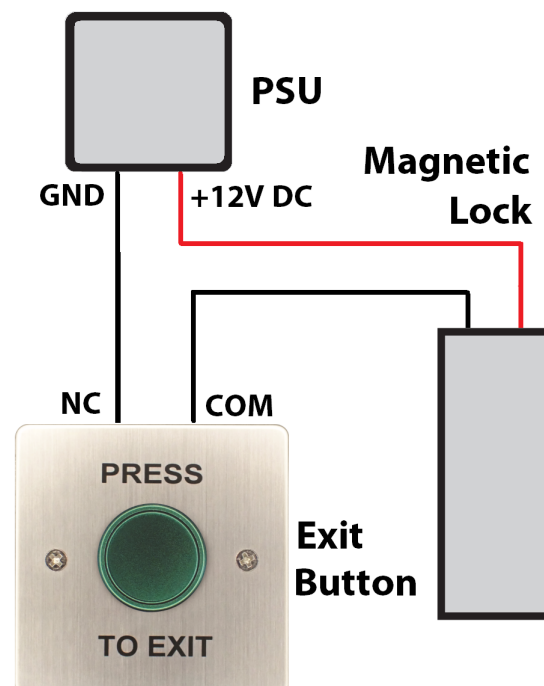

button isn't situated next to the door and a timed released is required.

Mounting

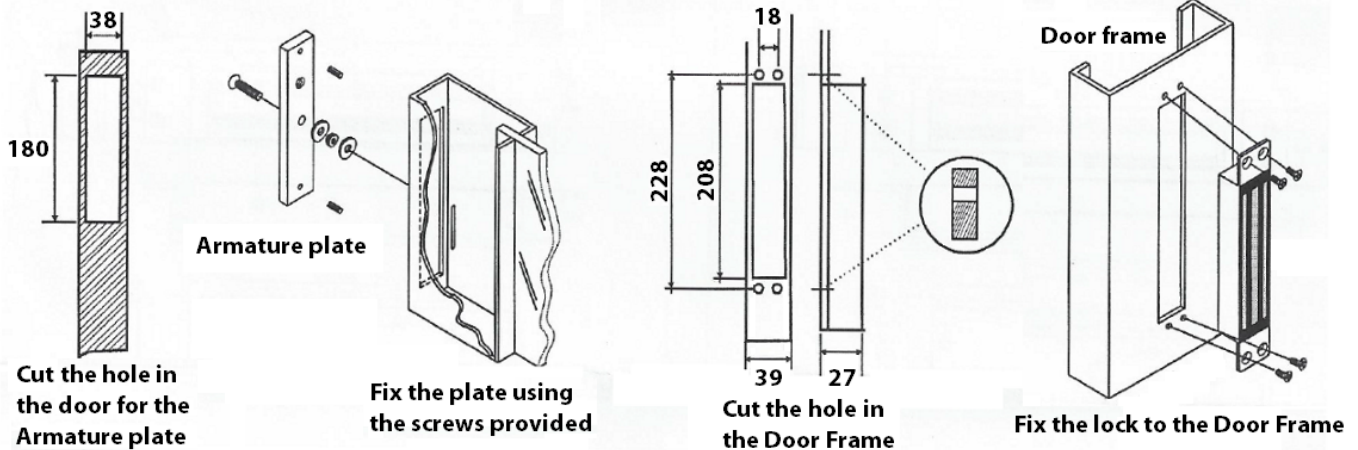

Connections

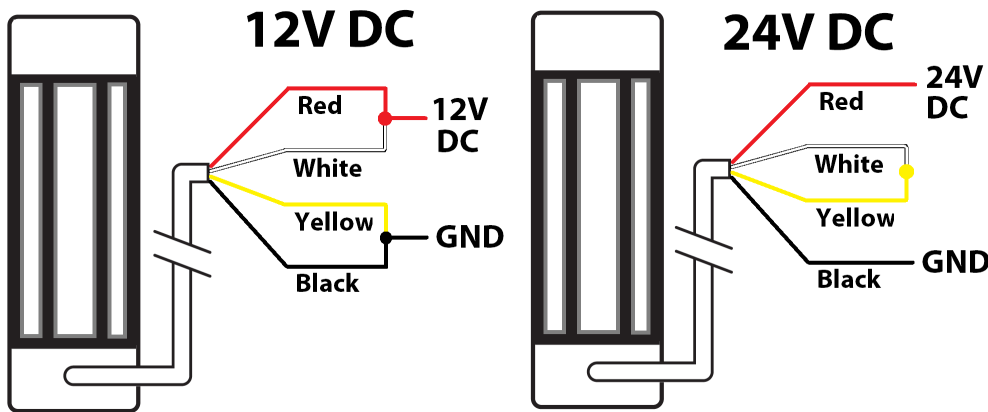

Troubleshooting

If the door release is not activating the lock then there is likely a shorted wire, open circuit or some other failed device in the circuit.

To identify where the fault is, each wired connection in the circuit needs to be tested; working from the door release progress through, including the power supply and the magnetic lock.

If the fault is with the door release then check the connection wires for continuity and for trapped wires. Check for water ingress on the wired connections. Check the polarity in the power connections and ensure the connections are connected to the proper terminals.

Specification	ACC512
Design	Mortice Mount
Holding Force	280kg (600lbs)
Delay	No delay (Mimic)
Relay Output	N/A
Voltage	12V DC 440mA / 24V DC 290mA
Construction	Metal Frame
Dimensions	(H) 38 x (W) 230 x (D) 28mm (Lock)

All specifications are approximate. System Q Ltd reserves the right to change product specifications or features without notice. Whilst every effort is made to ensure that these instructions are complete and accurate, System Q Ltd cannot be held responsible for any losses, no matter how they arise, from errors or omissions in these instructions, or the performance or non-performance of the equipment referred to.

