

CODE: LAM757

INFRARED ILLUMINATOR



INSTALLATION & OPERATION

STEP 1:

Secure Bracket ③ onto the desired ceiling or wall; then position it with the 4 screws as shown in Figure 1. You may also attach Bracket ③ by securing onto as other wall-mount type Bracket as shown in Figure 2.

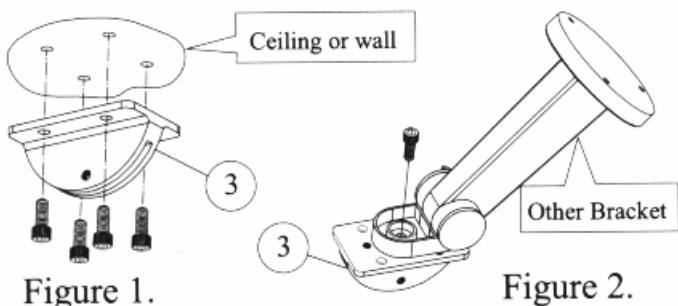

SPECIFICATION

Design & specifications are subject to change without prior notice)

MODEL	LAM757
ILLUMINATION	Up to 30 meters
BEAM SPREAD	40°
WAVE LENGTH	850nm
INFRARED LUMINARY	98 x IR LED's
ILLUMINATOR ACTIVE LIMIT	Under 10 Lux (linear control)
CONSTRUCTION	Aluminium case, IP66 weatherproof design
FILTER	Tempered glass
POWER CONSUMPTION	1.5A 12V PSU Required
OPERATION TAMP.	-10°C ~ 55°C
WEIGHT	1.2 kg
DIMENSIONS	Ø104.7 X 182.5 (L) mm

FEATURES

- High performance Infrared Illuminator.
- Effective range of up to 30 meters and beam spread at 40°.
- To assist cameras in providing a clear image under completely dark area.
- Utilising invisible infrared with 850nm wavelength.
- Built-in 98 pieces long life infrared Light-Emitting Diode, supporting over 6000 hours life.
- Built-in Cds light-source sensor can detect environment light source and automatically turn on/off the infrared illuminator.
- Weatherproof Suitable for Indoor and Outdoor use.

STEP 2:

Secure Bracket ② and the Infrared Illuminator onto Bracket ③, using the screws as shown in Figure 3. for ceiling or bracket mounting.

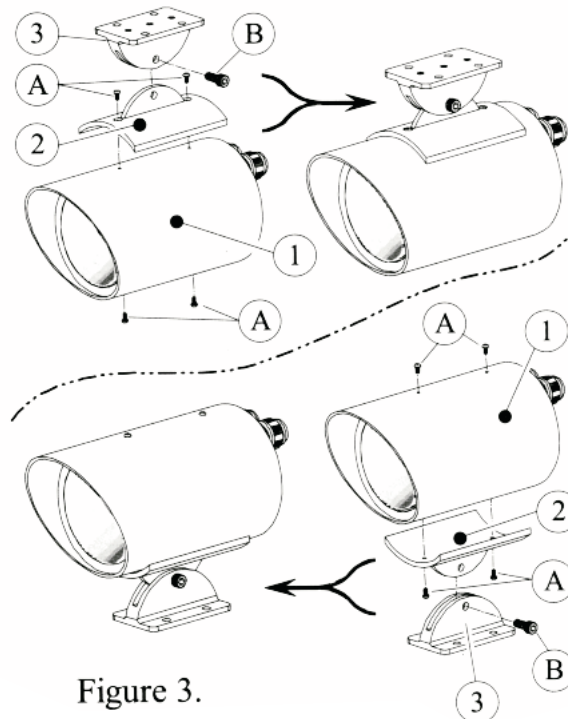

WARNING

- When installing the unit, please avoid pointing it directly at paper or flammable materials.
- When the unit is in use, it is normal for the unit's outer shell to reach a temperature of 60°C.
- The lenses used in the unit are tempered glass. All direct contact should be avoided to eliminate contamination. Please use cotton balls dipped in cleaning alcohol for cleaning.



CAUTION: Do not stare into the light beam of any LED at close range.

All specifications are approximate. System Q reserves the right to change any product specification or features without notice. Whilst every effort is made to ensure that these instructions are complete and accurate, System Q cannot be held responsible in any way for any losses, no matter how they arise, from errors or omissions in these instructions, or the performance or non-performance of the camera or other equipment that these instructions refer to. © All contents are subject to copyright, System Q Ltd 2005.