

## 16-in-1 USB2 CARD READER

### Product information

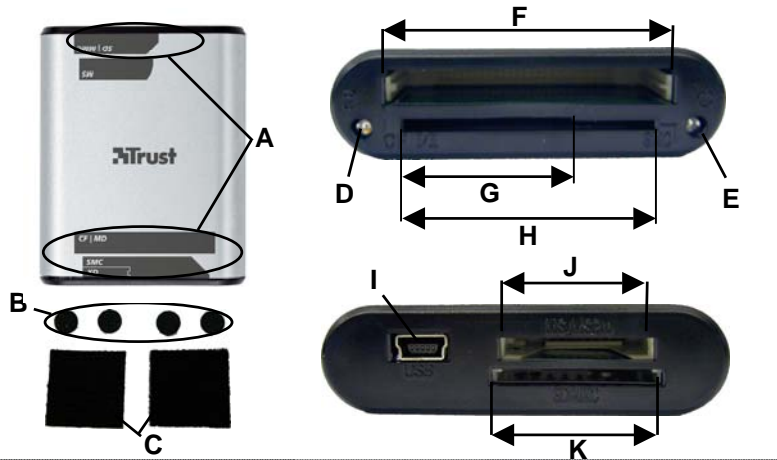

UK

- A: Card insertion symbols
- B: Rubber feet
- C: Velcro tape
- D: Activity indicator
- E: Power indicator

- F: Slot: CF I, CF II, MD
- G: Slot: XD
- H: Slot: SMC SM-RAM

- I: USB port
- J: Slot: MS, MS pro, MS-Duo, MS-Pro Duo (MS-MG) MS Select
- K: Slot: SD, Mini SD, MMC, RS-MMC

### Installation



Use rubber feet for use on desk  
Or → 2

16-in-1 USB2 CARD READER

2



Use Velcro tape

3

Windows XP/2000/ME/XP 64bit/MCE  
Windows 98 SE → 5

4

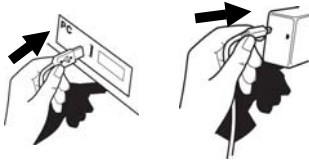

**Windows XP/2000/ME/64bit/MCE**  
Connect card reader

5

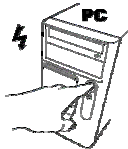

Computer on  
⚠ Wait until automatic installation is finished.

**Windows 64 bit: Finish**

6



Place CD in CD-ROM

## 16-in-1 USB2 CARD READER

UK

7



Install driver

8



Select Language  
Next (2x)

9



- 1) Yes, I want to restart my computer now.
- 2) Finish → Computer restarts
- 3) Windows XP/2000/ME/MCE → 11  
Windows 98 SE → 10

## 16-in-1 USB2 CARD READER

10

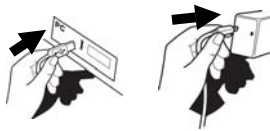

### Windows 98 SE

Connect card reader

11



Indicator (E) lights

Finish (card reader is ready for use)

### Card type icons



- My Computer
  - 3 1/2 Floppy (A:)
  - WIN (C:)
  - Compact Flash (D:)
  - Smartmedia card (E:)
  - MMC SD card (F:)
  - Memory Stick (G:)
  - XD card (H:)

D: CF or MD

E: SMC, SM- RAM

F: SD, Mini SD, MMC, RS-MMC

G: MS, MS pro, MS-Duo, MS-Pro Duo (MS-MG), MS Select.

H: XD card

⚠ Drive letters might differ, depending on users system

⚠ Windows 98 SE and XP 64 bit: standard drive names

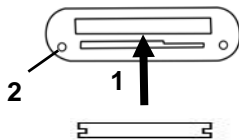

- My Computer
  - 3 1/2 Floppy (A:)
  - WIN (C:)
  - Compact Flash (D:)
  - Smartmedia card (E:)
  - MMC SD card (F:)
  - Memory Stick (G:)
  - XD card (H:)

3

CF or MD

1. Insert card

2. Active LED (D) lights

3. Drive icon pops up coloured

## 16-in-1 USB2 CARD READER

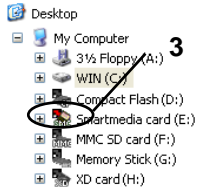
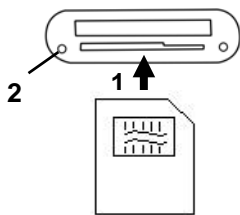

SMC or SM-RAM

1. Insert card
2. Active LED (D) lights
3. Drive icon pops up coloured

UK

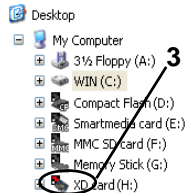
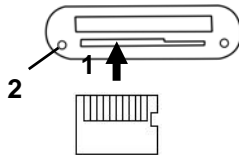

XD

1. Insert card
2. Active LED (D) lights
3. Drive icon pops up coloured

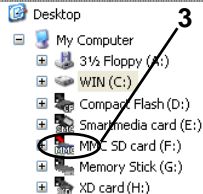
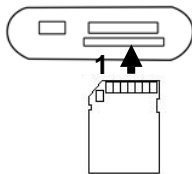

SD, Mini SD, MMC, RS-MMC

1. Insert card
2. Active LED (D) lights
3. Drive icon pops up coloured

⚠ Use adapter for Mini SD and RS-MMC cards

## 16-in-1 USB2 CARD READER

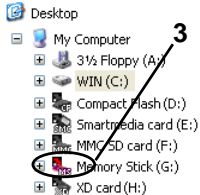
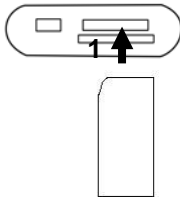











MS, MS pro, MS-Duo, MS-Pro Duo (MS-MG) , MS Select

1. Insert card
2. Active LED (D) lights
3. Drive pops up coloured

 Use adapter with MS (pro) duo cards

### Reminders

-  Place card into the reader in a wrong direction may cause damage to the device
-  Don't force a card into a slot when it does not fit in
-  If you format a card on your computer and then use it in your digital camera or other portable device, the device may no longer recognize the format of the card. It is, therefore, recommended to always format the card using your digital camera or the portable devices
-  Check if it's write protected when you are not able to copy data to a card
-  If you experience intermittent problems after Windows resumes from sleep, hibernation or computer inactivity: go to Device Manager > Universal Serial Bus Controllers > USB Root Hub > Power Management, Uncheck the box "Allow computer to turn off this device to save power". Uncheck all boxes on all root hubs
-  Do not remove a card when the active indicator (D) is still blinking otherwise the data may not be read or written correctly
-  RS-MMC and mini SD needs adapter for using in cardreader.
-  Inappropriate use may result in the loss of your data. Trust is not directly or indirectly responsible for this.
-  Power indicator (E) only lights after Windows (driver) has recognised cardreader.
-  Active indicator (D) lights during reading/writing, or errors.
-  Always remove cards in safe removal mode

## 16-in-1 USB2 CARD READER



### Cards supported:

Type	Size	Type	Size	Type	Size	Type	Size
SMC	8MB ~ 128MB	CF II	Up to ~ 2.0GB	MMC	Up to ~ 256MB	MS Pro	Up to ~ 1GB
RS-MMC	Up to 256MB	MD	up to ~ 2.2GB	Mini SD	Up to ~ 512MB	MS Duo	64MB, 128MB
CF I	Up to ~ 1GB	SD	32MB ~ 512MB	MS (MG)	64MB ~ 128MB	MS-Pro Duo	Up to ~ 1GB
XD	Up to ~ 512 MB	SM- RAM	8MB ~ 128MB	MS Select	256 MB		

UK

Due to the continuous development of memory card capacity, it can be possible that cards with a higher capacity than mentioned are supported.

### Safety

- Do not repair this device.
- Keep this device away from liquids, such as water.



- This device meets the essential requirements and other relevant conditions of the applicable European directives. The Declaration of Conformity (DoC) is available at [www.trust.com/14326/ce](http://www.trust.com/14326/ce)



- If possible, dispose of the device at a recycling centre. Do not dispose of the device with the household waste.